

TODAY'S FIRES FOR TODAY'S LIVING





ASPEN

ECR NoVo

TARRAS



FLARE



TASMAN



TOTARA

BIG LOGS. BIG HEAT.

TARRAS

When it comes to heating up large spaces quickly and keeping them cosy, the Tarras MKIII gets straight down to business. It's the benchmark in large fires with a high-capacity firebox and sustained heat output that has the power to drive warmth into every corner of your home.

- ◆ Clean air approved for all zones
- ◆ Water heating option (wetback)
- ◆ Cook top



76_L
FIREBOX
CAPACITY

23.4^{kW}
LAB TEST
HEAT OUTPUT

240_{m²}
HOME
HEATING AREA

15
YEARS
FIREBOX
WARRANTY

1
YEAR
PARTS
WARRANTY



SHOW YOUR FLAIR

FLARE

Your home reflects your sense of style and individuality so the fire that you put at the heart of it should too. Designed for medium-sized spaces, the Flare stands apart from other fires and makes a statement all of its own.



- ◆ Clean air approved (except in 0.7 zones)
- ◆ Three colour options: Red Brown, Metallic Brown, Charcoal
- ◆ Three base options: Pedestal, Legs and Wood Box
- ◆ Water heating option (wetback)

56_L
FIREBOX
CAPACITY

17.1_{kW}
LAB TEST
HEAT OUTPUT

180_{m²}
HOME
HEATING AREA

15
YEARS
FIREBOX
WARRANTY

1
YEAR
PARTS
WARRANTY

Base options

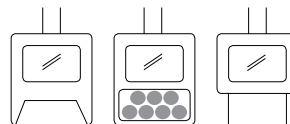

Colour options





ABLE TASMAN

TASMAN

Traditional styling comes together with a modern, easy-clean pedestal base. Designed for medium to large living areas, the Tasman MKII combines the best of traditional and contemporary styling.

- ◆ Clean air approved for all zones
- ◆ Water heating option (wetback)
- ◆ Cook top



56_L
FIREBOX
CAPACITY

19^{.6}_{kW}
LAB TEST
HEAT OUTPUT

190_{m²}
HOME
HEATING AREA

15
YEARS
FIREBOX
WARRANTY

1
YEAR
PARTS
WARRANTY



HOME ON THE RANGE

ASPEN

Embracing NZ's rustic heritage, this traditionally styled centerpiece conveys an understated elegance that will never date. Designed for medium to large living spaces, the Aspen is your dependable companion for those long winter nights.

- ◆ Clean air approved for all zones
- ◆ Water heating option (wetback)
- ◆ Cook top



56_L
FIREBOX
CAPACITY

19^{.6}_{kW}
LAB TEST
HEAT OUTPUT

190_{m²}
HOME
HEATING AREA

15
YEARS
FIREBOX
WARRANTY

1
YEAR
PARTS
WARRANTY



THE LITTLE FIRE THAT CAN

ECR NoVo

It's a compact package, but don't be deceived - this little fire punches above its weight and will keep your small to medium-sized living area toasty warm for years to come. Offering great value, super reliability and coloured side panels to fit your décor, the ECR NoVo is the little fire that can.

- ◆ Clean air approved (except in 0.7 zones)
- ◆ Ultra-durable 6 mm steel firebox
- ◆ Cook top
- ◆ Colours options additional: Red, Brown, Pewter and Metallic Black (standard)



Colour options



32_L
FIREBOX
CAPACITY

15^{.7}_{kW}
LAB TEST
HEAT OUTPUT

130_{m²}
HOME
HEATING AREA

15
YEARS
FIREBOX
WARRANTY

1
YEAR
PARTS
WARRANTY



A GREAT PERFORMER

TOTARA

It's the perfect option for upgrading your brick open fireplace or a stylish choice for keeping your modern home snug and warm. With many years of proven performance, the Totara has stood the test of time and delivers exceptional value for money.

- ◆ Clean air approved (except in 0.7 zones)
- ◆ Ultra-durable 6 mm steel firebox
- ◆ Zero clearance box available (for timber framing)



33_L
FIREBOX
CAPACITY

13^{.7}_{kW}
LAB TEST
HEAT OUTPUT

120_{m²}
HOME
HEATING AREA

15
YEARS
FIREBOX
WARRANTY

1
YEAR
PARTS
WARRANTY

DESIGNED FOR HIGH PERFORMANCE...

HEATSAVER™ FLUE

high-efficiency
HEATSAVER™ flue draws
cooling air from outside

HIGH TEMPERATURE SILICON PAINT

easy-care, easy-repair paint
finish of choice, exclusively
from PLP**COATINGS**™
in Belgium



HAND CRAFTED

welded by hand for long
lasting joints that withstand
extreme temperatures

T304 STAINLESS STEEL BAFFLES

high-quality stainless steel
welded baffles for longer
life and efficient burning

BUILT TO LAST!

TOUGH BRICKS

long lasting, compressed Vermiculite SKAMOLEX™ fire bricks, designed to withstand extreme temperatures

LONG LASTING PARTS

use of only the best materials to ensure maximum life of consumable parts

CERAMIC GLASS

highest quality glass supplied by SCHOTT ROBAX®, leaders in fireplace glass

HIGH CARBON STEEL

6-8mm steel plate used for high construction strength and ultimate firebox longevity

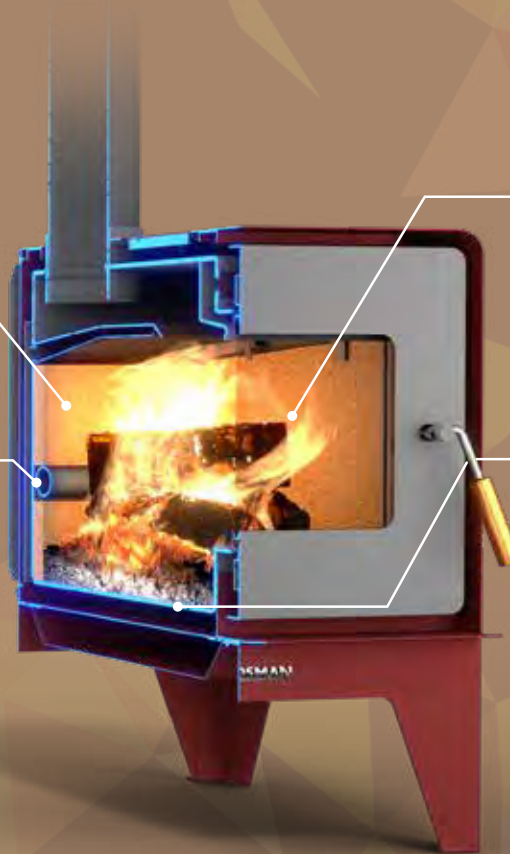

LOW PROFILE STEEL FLOOR PROTECTORS

HEARTH SPECIFICATIONS

Shape options:

Wall



Corner

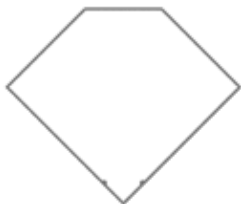

Colour options:

Charcoal



Black



Recommended for:



Tarras MKIII



Tasman MKII



ECR NoVo

Use an ash floor protector or any non-combustible material

LOW PROFILE FLOOR PROTECTORS

A range of attractive steel floor protectors are available to suit certain Woodsman models, offering you an easy and safe solution for your installation needs.

- ◆ Easy-clean powder-coated finish
- ◆ Wall or Corner options
- ◆ Available in Black and Charcoal
- ◆ Stub-proof design
- ◆ 4mm finished thickness

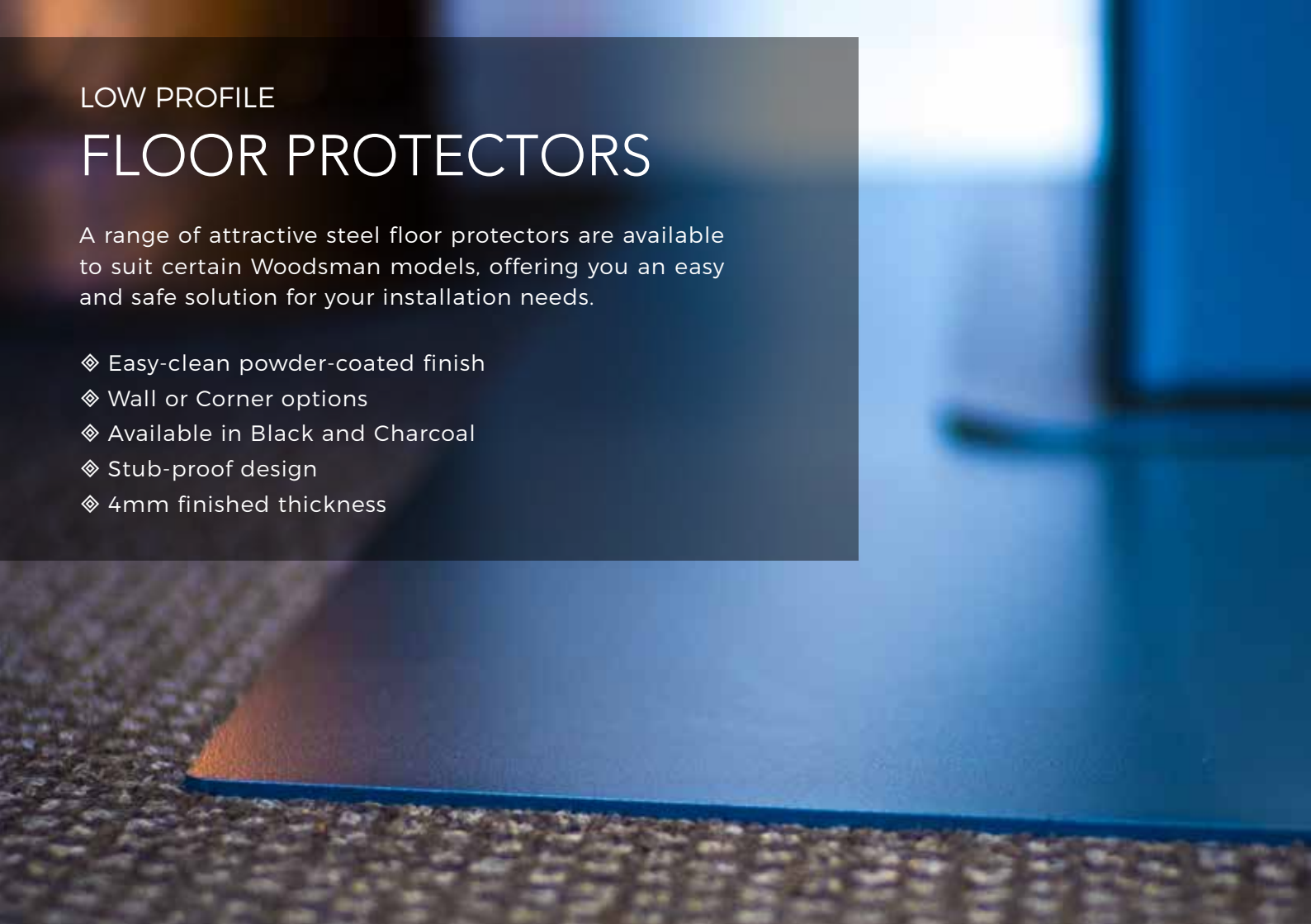

HIGH EFFICIENCY

HEATSAVER™ FLUE SYSTEM

The HeatSaver™ Flue System allows you to heat your home more efficiently by retaining the heat inside your home. The system draws its cooling air from either inside the ceiling cavity or outside the home, thereby retaining precious warmth.

Insist on a Heatsaver™ Flue System with your new Woodsman fire and enjoy increased warmth through greater efficiency.

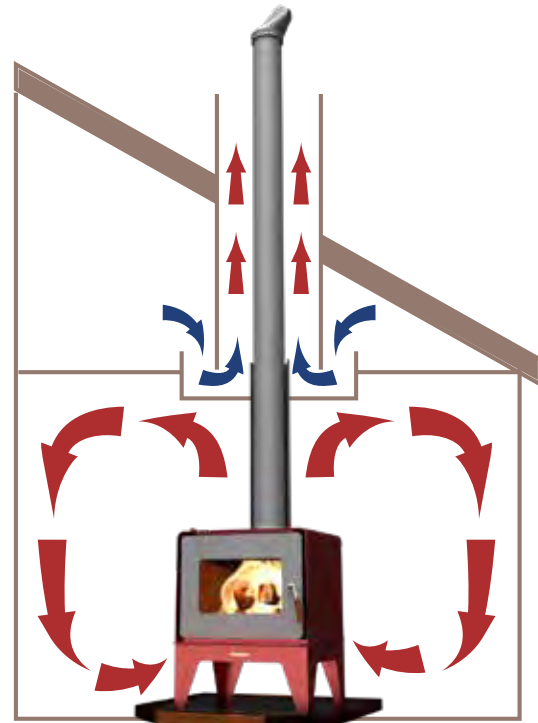

HIGH PERFORMANCE FLUE KIT

- ◆ Easy to install
- ◆ Two storey and sloping ceiling kits available
- ◆ Stainless steel option for coastal regions

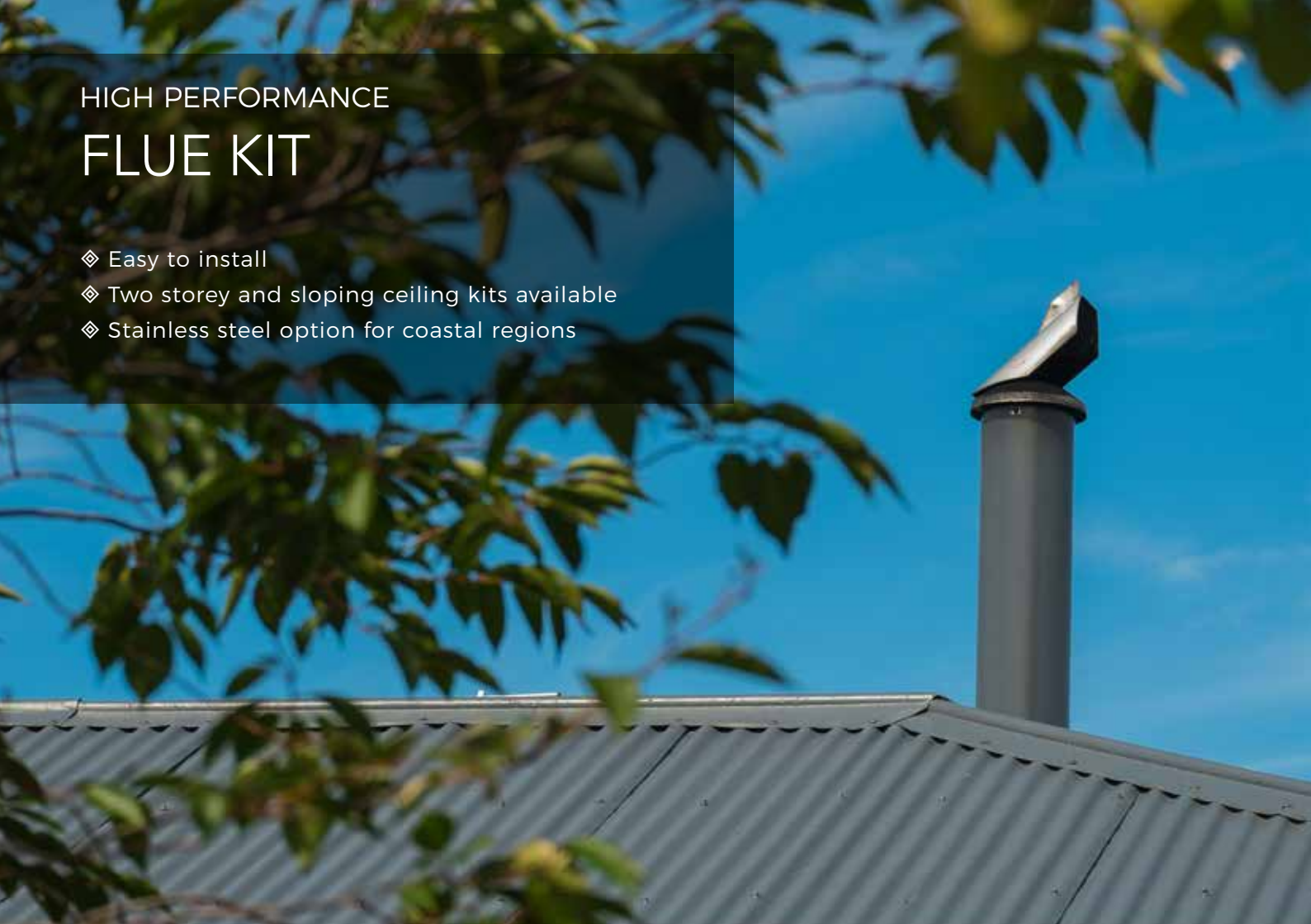

FLARE

PEDESTAL

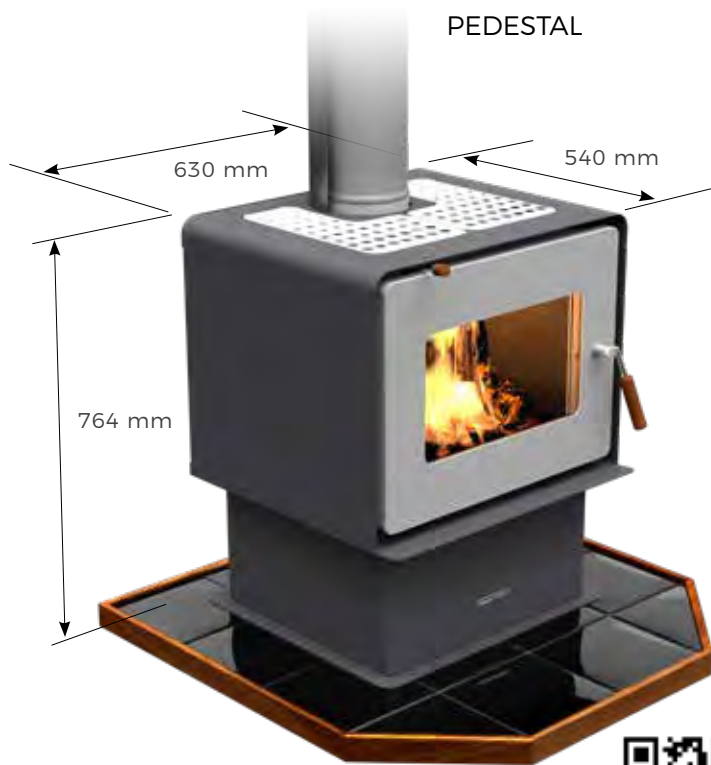

woodsman.co.nz/flare-ped

BOX

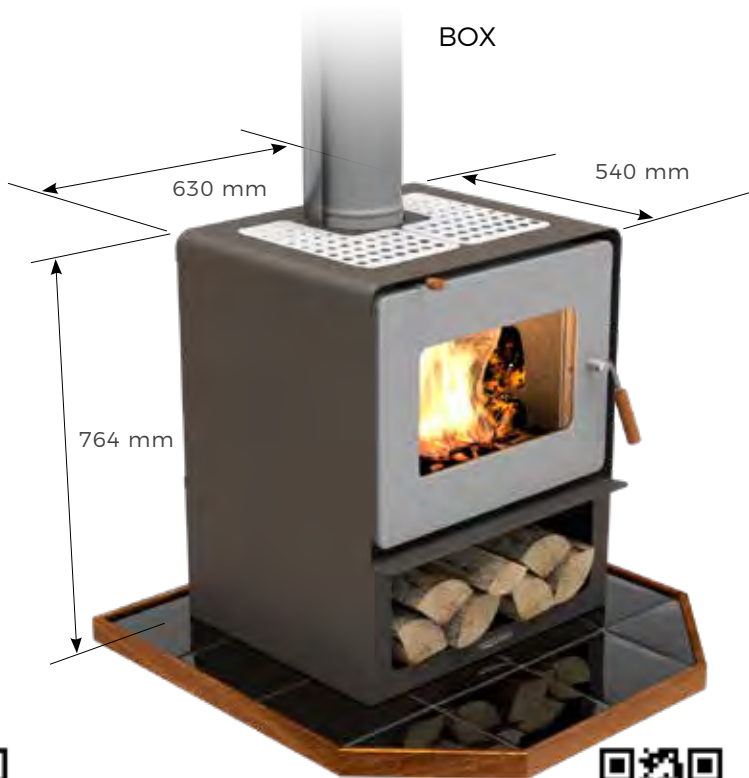

woodsman.co.nz/flare-box

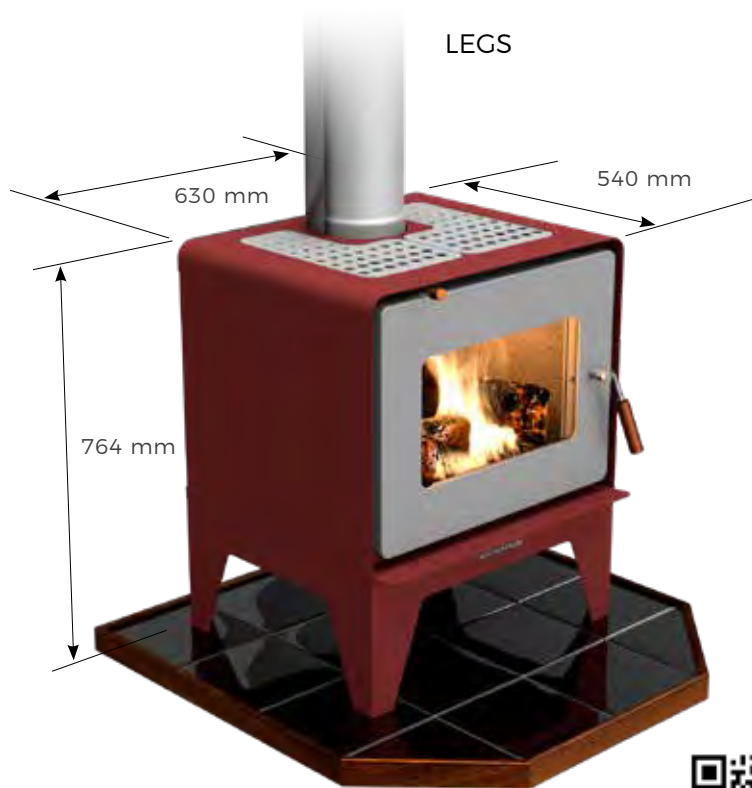

woodsman.co.nz/flare-legs

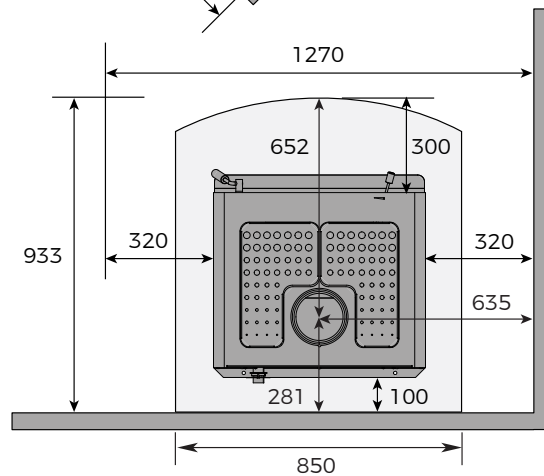
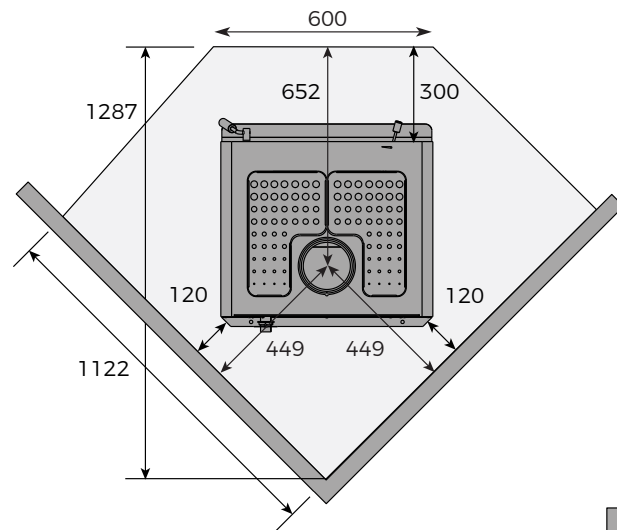

TARRAS MKIII



woodsman.co.nz/tarras

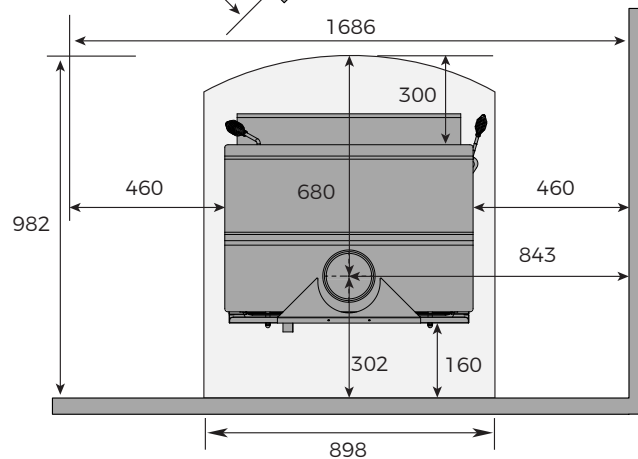
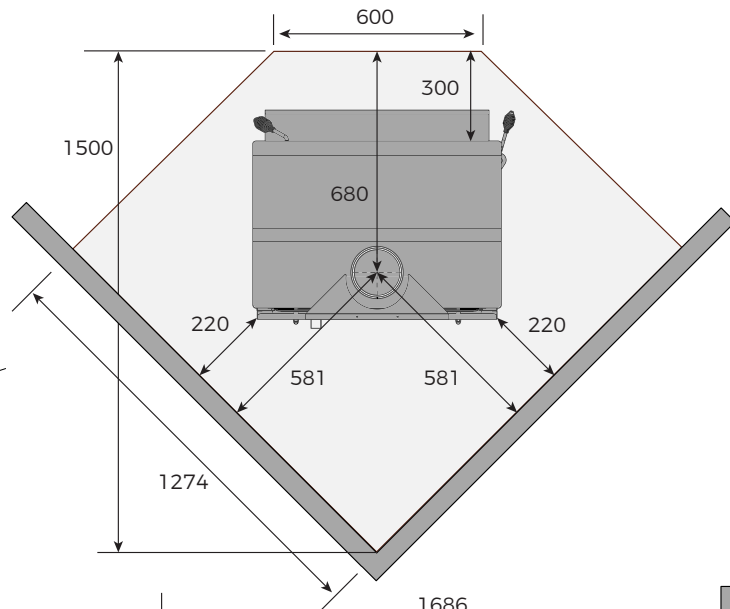

TASMAN MKII



woodsman.co.nz/tasman

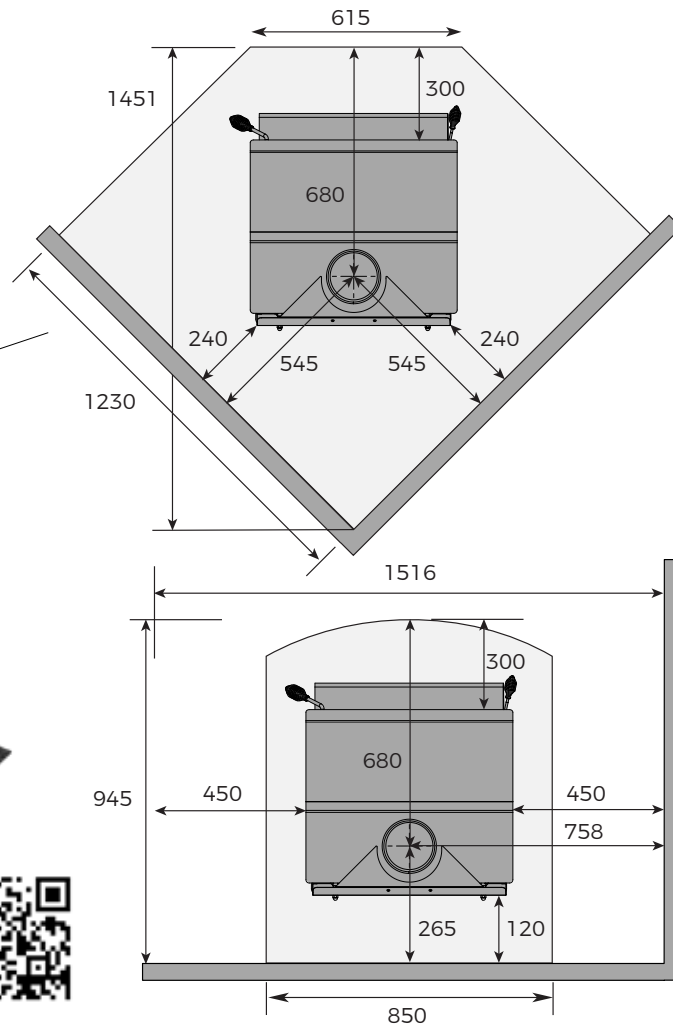

NOTE: All specifications are subject to change without notification. Please refer to the installation instructions when installing your Woodsman fire.

ASPEN

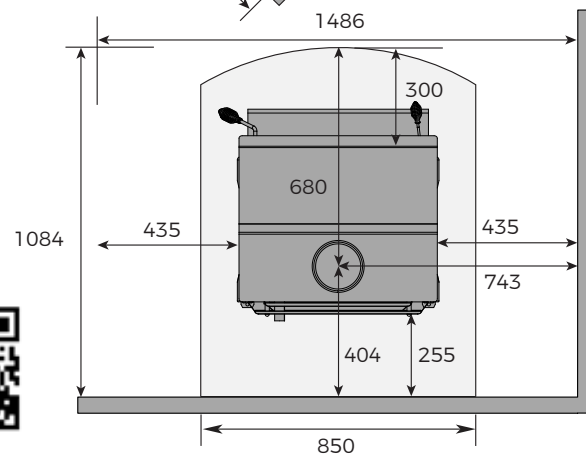
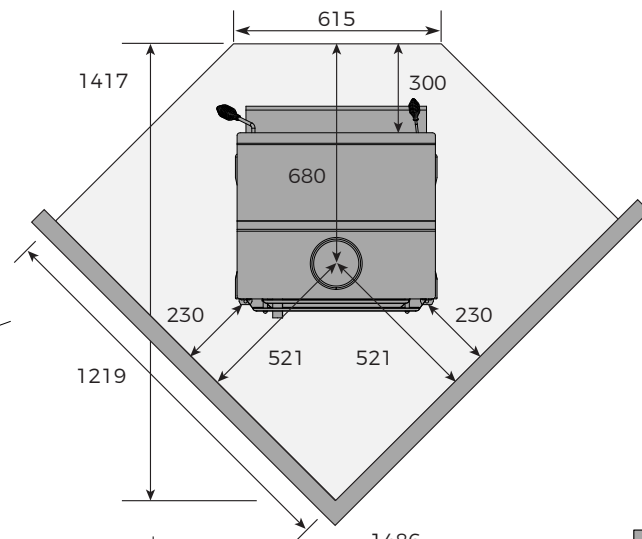
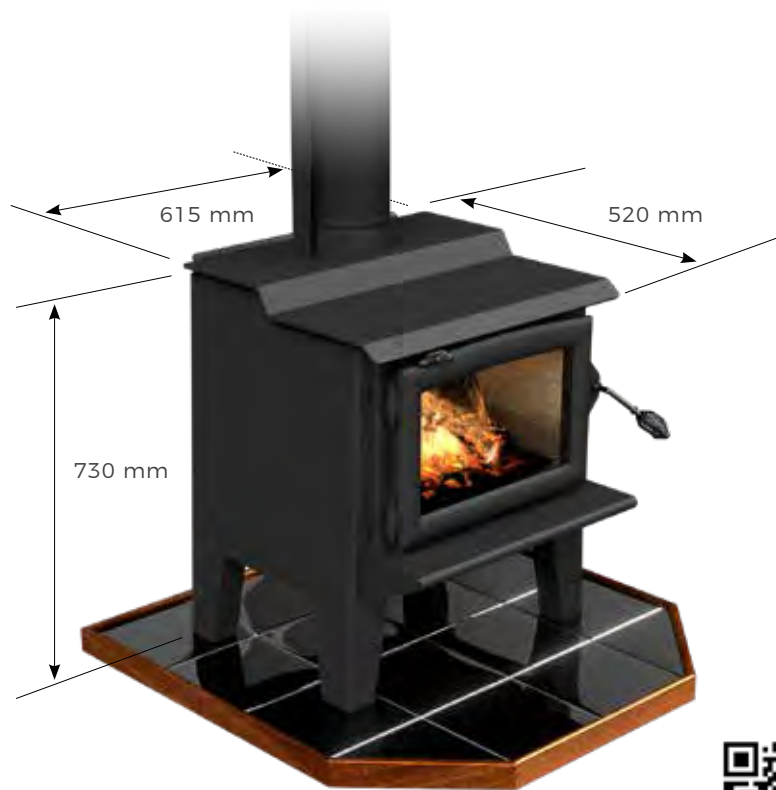

woodsman.co.nz/aspen

ECR NoVo



woodsman.co.nz/ecr-novo

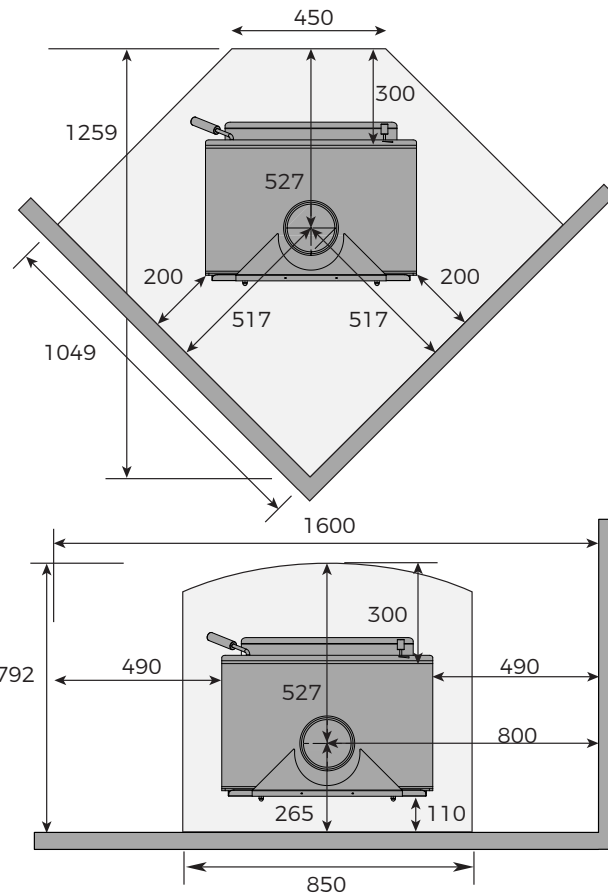

TOTARA



woodsman.co.nz/totara

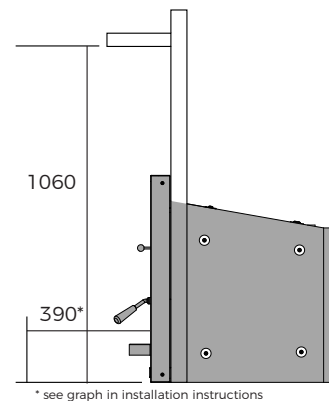
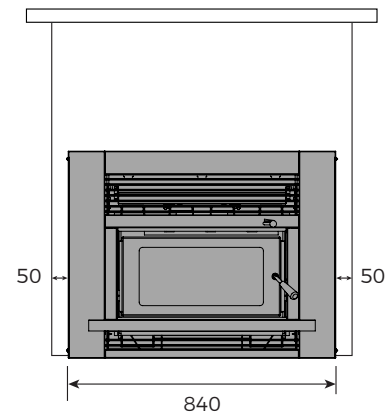



Harris Home Fires have been keeping fires at the heart of Kiwi homes since 1887. A family business for 5 generations, it remains committed to hand crafting your fire to the most exacting standards, right here in New Zealand.





WOODSMAN